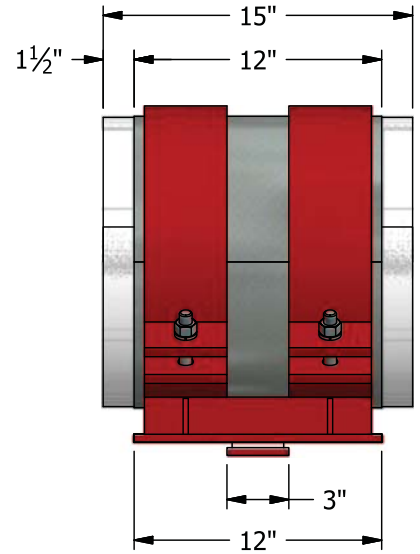
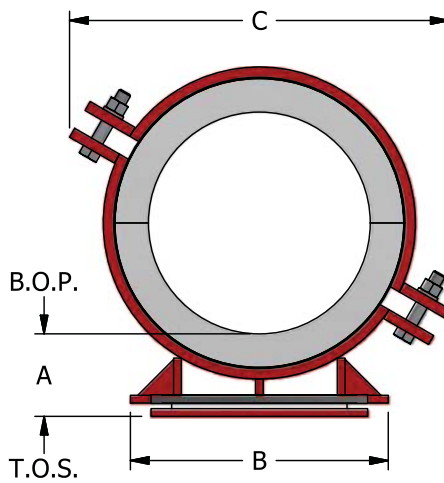
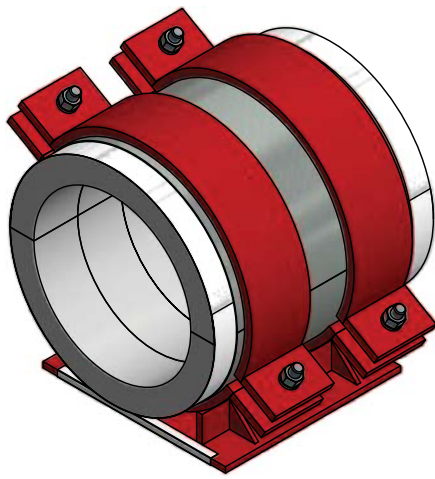



**FIG. NS60**

**Pre-Insulated Sliding Pipe Support**  
 ± 4 1/2" Axial Movement, Lateral Movement as Noted



Ordering: Fig. NS60 - (Pipe Size) x (Insulation Thickness) - (Insulation Grade)(Finish) e.g. NS60-8x2-5H

| PIPE SIZE | VERT. LOAD GRADE 5 | VERT. LOAD GRADE 6 | INS. THK. = 1"       |      |       | INS. THK. = 1 1/2"   |      |       | INS. THK. = 2"   |      |       | INS. THK. = 2 1/2"   |      |       | INS. THK. = 3"       |      |       | INS. THK. = 4"   |      |       |
|-----------|--------------------|--------------------|----------------------|------|-------|----------------------|------|-------|------------------|------|-------|----------------------|------|-------|----------------------|------|-------|------------------|------|-------|
|           |                    |                    | LAT. MOV'T. ± 1 1/2" |      |       | LAT. MOV'T. ± 1 3/4" |      |       | LAT. MOV'T. ± 2" |      |       | LAT. MOV'T. ± 2 1/4" |      |       | LAT. MOV'T. ± 2 1/2" |      |       | LAT. MOV'T. ± 3" |      |       |
|           |                    |                    | A                    | B    | C     | A                    | B    | C     | A                | B    | C     | A                    | B    | C     | A                    | B    | C     | A                | B    | C     |
| 2"        | 1100               | 1500               | 4                    | 6    | 8.813 | 4                    | 6.5  | 9.75  | 5                | 8    | 10.69 | 5                    | 9    | 11.56 | 6                    | 10.5 | 12.44 | 6                | 13.5 | 14.25 |
| 2 1/2"    | 1350               | 1800               | 4                    | 6    | 9.25  | 4                    | 7.5  | 10.69 | 5                | 8.5  | 11.56 | 5                    | 10   | 12.44 | 6                    | 11.5 | 13.25 | 6                | 14   | 15.13 |
| 3"        | 1600               | 2100               | 4                    | 6    | 9.75  | 4                    | 7.5  | 10.69 | 4                | 8.5  | 11.56 | 5                    | 10   | 12.44 | 6                    | 11.5 | 13.25 | 6                | 14   | 15.13 |
| 4"        | 2500               | 3350               | 4                    | 7    | 10.69 | 4                    | 8    | 11.56 | 4                | 9.5  | 12.44 | 5                    | 11   | 13.25 | 6                    | 12.5 | 14.25 | 6                | 15   | 16    |
| 5"        | 3100               | 4200               | 4                    | 7.5  | 12.25 | 4                    | 9    | 13.06 | 4                | 10.5 | 13.94 | 5                    | 12   | 14.94 | 6                    | 13   | 15.81 | 6                | 15.5 | 17.75 |
| 6"        | 3800               | 5100               | 4                    | 8.5  | 13.06 | 4                    | 10   | 13.94 | 4                | 11.5 | 14.94 | 5                    | 12.5 | 15.81 | 6                    | 14   | 16.69 | 6                | 16.5 | 18.63 |
| 8"        | 5100               | 6800               | 4                    | 10.5 | 14.94 | 4                    | 11.5 | 15.81 | 4                | 13   | 16.69 | 6                    | 14   | 17.75 | 6                    | 15.5 | 18.63 | 6                | 18   | 20.38 |
| 10"       | 6000               | 8000               | 4                    | 12   | 17.31 | 4                    | 13   | 18.38 | 4                | 14.5 | 19.25 | 6                    | 15.5 | 20.13 | 6                    | 17   | 21    | 6                | 19   | 22.75 |
| 12"       | 6600               | 8800               | 4                    | 13.5 | 19.25 | 4                    | 14.5 | 20.13 | 4                | 16   | 21    | 6                    | 17   | 21.88 | 6                    | 18   | 22.75 | 6                | 20.5 | 24.5  |
| 14"       | 7500               | 10000              | 4                    | 14   | 20.13 | 4                    | 15.5 | 21    | 4                | 16.5 | 21.88 | 6                    | 17.5 | 22.75 | 6                    | 19   | 23.63 | 6                | 21.5 | 25.31 |
| 16"       | 8700               | 11600              | 4                    | 15.5 | 23.19 | 4                    | 16.5 | 24.06 | 6                | 18   | 24.94 | 6                    | 19   | 25.81 | 6                    | 20.5 | 26.69 | 8                | 22.5 | 28.38 |
| 18"       | 9600               | 12800              | 4                    | 17   | 24.94 | 4                    | 18   | 25.81 | 6                | 19.5 | 26.69 | 6                    | 20.5 | 27.5  | 6                    | 21.5 | 28.38 | 8                | 24   | 30.13 |
| 20"       | 10200              | 13600              | 4                    | 18.5 | 26.69 | 4                    | 19.5 | 27.5  | 6                | 20.5 | 28.38 | 6                    | 22   | 29.25 | 6                    | 23   | 30.13 | 8                | 25.5 | 31.88 |
| 24"       | 10800              | 14400              | 4                    | 21   | 30.13 | 4                    | 22.5 | 31    | 6                | 23.5 | 31.88 | 6                    | 25   | 32.75 | 6                    | 26   | 33.63 | 8                | 28.5 | 35.31 |
| 30"       | 14100              | 18800              | 4                    | 25.5 | 35.81 | 6                    | 26.5 | 36.63 | 6                | 28   | 37.5  | 6                    | 29   | 38.38 | 6                    | 30   | 39.25 | 8                | 32.5 | 41    |
| 36"       | 16500              | 22000              | 4                    | 29.5 | 43.63 | 6                    | 31   | 44.5  | 6                | 32   | 45.38 | 6                    | 33   | 46.25 | 6                    | 34.5 | 47.13 | 8                | 37   | 48.81 |
| 42"       | 18600              | 24800              | 4                    | 34   | 48.81 | 6                    | 35   | 49.69 | 6                | 36.5 | 50.56 | 6                    | 37.5 | 51.44 | 6                    | 38.5 | 52.31 | 8                | 41   | 54.06 |

|   |  |   |
|---|--|---|
| <p><b>Applications:</b></p> <ul style="list-style-type: none"> <li>• Allows large axial travel and moderate lateral travel while providing vertical support</li> <li>• Designed for use on:<br/>Chilled Water    Hot Water    Steam</li> <li>• Installation: welded to flat steel surface</li> <li>• Temperature Range: +20°F to +1200°F</li> <li>• Axial Movement: ± 4 1/2"</li> <li>• Lateral Movement: Varies</li> </ul> | <p><b>Features:</b></p> <ul style="list-style-type: none"> <li>• Eliminates welding to pipe</li> <li>• Provides continuous, zero permeability vapor barrier</li> <li>• Insulation extends beyond shield 1 1/2" each side</li> <li>• Structural insulation for load transfer</li> <li>• Stainless steel to UHMW polyethylene slide</li> <li>• Static Coefficient of Friction = 0.15</li> <li>• ASTM E-84 Flame Spread/Smoke Developed: 10/20</li> <li>• Thermal Conductivity<br/>Grade 5 = 0.54 Btu•in/(hr•ft<sup>2</sup>•°F) @ 200°F<br/>Grade 6 = 0.61 Btu•in/(hr•ft<sup>2</sup>•°F) @ 200°F</li> <li>• Insulation chemically bonded</li> </ul> | <p><b>Material Data:</b></p> <p>Insulation: Calcium Silicate meeting ASTM C-585 and C-656 Type II<br/>                 Grade 5: 450 psi, 20 pcf<br/>                 Grade 6: 900 psi, 28 pcf<br/>                 other insulation materials, Page 34</p> <p>Base/Clamp: ASTM A-36 Carbon Steel<br/>                 Fasteners: ASTM A-307 Electro-Galv. Plated<br/>                 Slide: ASTM A-240 Type 304 Stainless Steel on UHMW Polyethylene<br/>                 Shield: ASTM A-653 G-90, 18 ga Galv. Steel<br/>                 Vapor Barrier: ASTM E-96 All Service Jacket<br/>                 Finishes: (H) Hot-Dip Galv. per ASTM A-123<br/>                 (P) Painted Red Shop Primer<br/>                 (B) Unfinished</p> |
|---|--|---|